

AgriCAD GC120



Owners Manual



Introduction

1. Foreword

Before operating the implement, read and strictly comply with the operating instructions. In doing so, you will avoid accidents, reduce repair costs and downtime and increase the reliability and service life of your implement. Pay attention to the safety instructions! AgriCAD will not assume liability for any damage or malfunctions resulting from failure to comply with the operating instructions.

These operating instructions will assist you in getting to know your implement and in using it correctly for its intended purposes. The operating instructions must be read and strictly adhered to by all persons working on or with the implement.

e.g. Operation (including preparation, fault rectification during work and servicing)
Maintenance (maintenance and inspection)

We reserve the right to alter illustrations as well as technical data and weights contained in these operating instructions for the purpose of improving the implement without notice.

2. Warranty claims

This implement carries a one year warranty on parts and workmanship.
Wear parts are not covered by this warranty.

3. Intended use

The implement was built in accordance with latest technical standards and generally accepted safety regulations. However, risks of injury to the operator or third parties and impairment of the implement or other tangible assets can occur during use.

The implement must only be operated for its intended use if in a technically good condition, whilst being aware of safety and risks and in strict compliance with the operating instructions!
Faults, particularly those which impair safety, must be remedied immediately. The implement must only be operated, serviced and repaired by persons who are familiar with it and have been made aware of the dangers involved.

Genuine spare parts and accessories from AgriCAD are available for this implement. Spare parts and accessories which are not supplied by AgriCAD, have not been tested or approved by AgriCAD. Installation or use of non-original AgriCAD products may have a detrimental effect on specific design features of the implement and impair the safety of implement operators and the implement itself. AgriCAD will not assume liability whatsoever for damage resulting from the use of non-original parts and accessories.

The implement was designed for the cleaning of grain in an agricultural application. Any other use beyond this limits, e.g. as a means of transport, is deemed improper.
AgriCAD will not assume liability whatsoever for damage resulting from unintended use. The risk will be borne solely by the user.

Intended use also includes the strict compliance with the operating instructions specified by the AgriCAD.

3.1 Consequential damage

The Implement was manufactured by AgriCAD with great care. Nevertheless, even when used properly, malfunctions or complete failure may be caused by e.g.:

Excessive wear due to the failing of a wear part.

Damage caused by external influences.

Incorrect or inappropriate drive speeds.

Incorrect operation of the implement.

You should therefore check the correct function of your implement before and during each use. Liability for consequential damages caused by operating faults is excluded.

3.2 Authorised operators

Operators must be at least 16 years of age.

The operator is responsible for third parties in the operating area.

Only those persons who have been authorised and instructed by the owner may operate the implement.

The owner must:

Make the operating instructions available to the operator.

Ensure that the operator understood the operating instructions.

The operating instructions are an integral part of the implement.

Safety and accident prevention

The following warnings and safety instructions apply to all sections in these operating instructions.

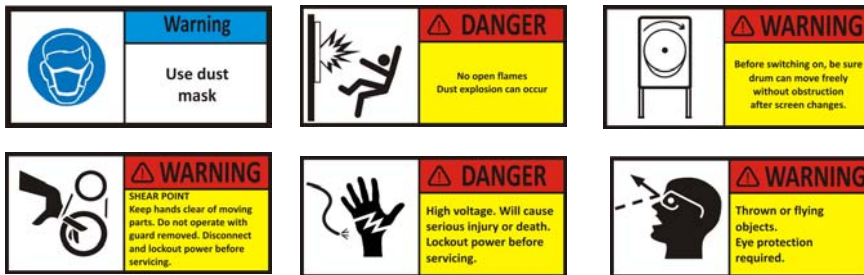

Example of Safety symbols

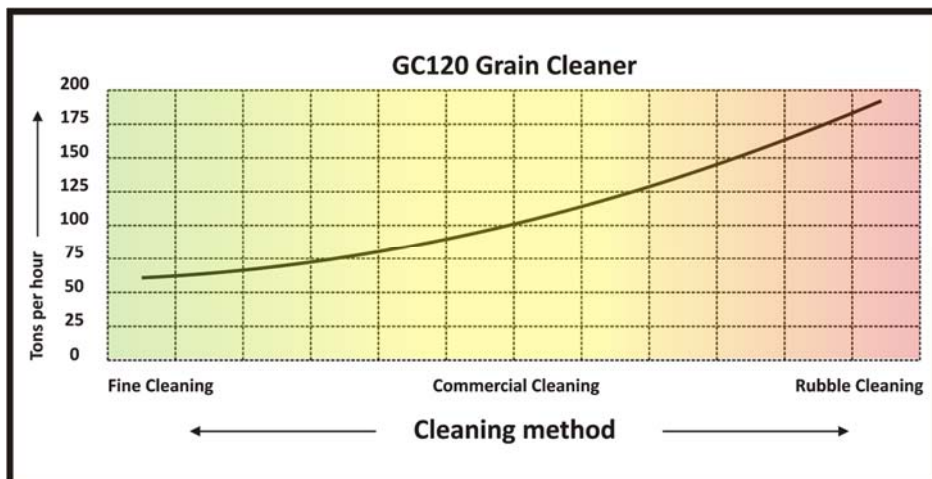

Operational safety

The implement registration form has to be completed and returned to AgriCAD.

All protective features and safety equipment, such as detachable protective devices, must be correctly in place and reliably functioning before the machine is put into operation.

Check and tighten nuts and bolts at regular intervals.

In case of malfunctions immediately stop and secure the machine.

Service and maintenance

Ensure that regular inspections are always carried out.

Prior to performing maintenance and servicing work, ensure that the implement is positioned on firm, level ground.

Before cleaning the implement with high pressure cleaning equipment cover all openings, which should stay clear of water, steam or cleaning agents for reasons of safety or operation.

Do not aim the water jet directly at electrical or electronic components.

Re-tighten screwed connections which have been loosened during servicing and maintenance work.

Take extreme caution when washing with steam-jet or high pressure washers implement can be damaged.

In operation

Check the area around the implement un authorised persons before starting operation of the implement.

Do not remove any of the mandatory and supplied protective devices.

Stay clear of the operating range of the roller.

Side panels must be closed at all times when implement is in use.

Technical data

Basic dimensions

Width:2.30 m
Height:5.40 m
Length:6.20 m

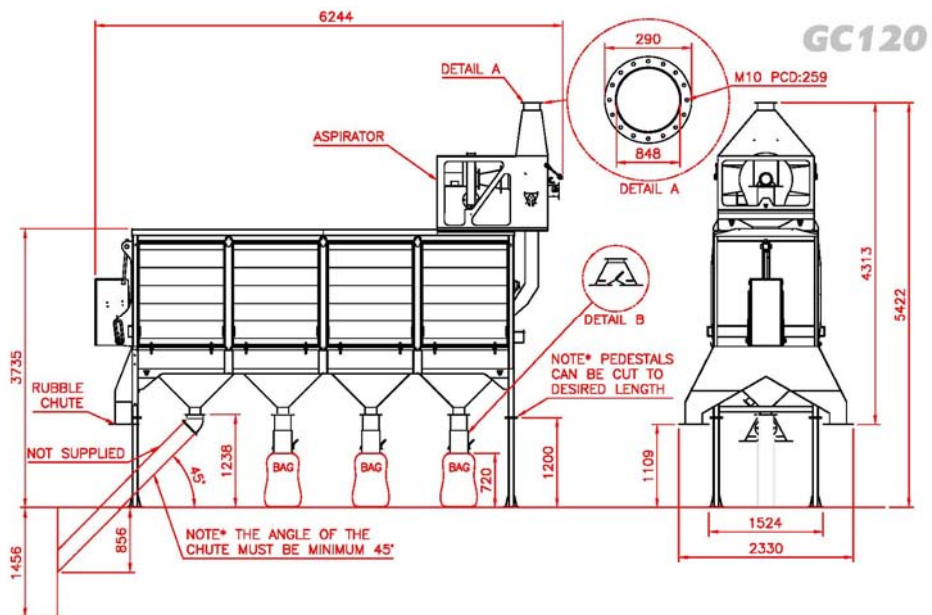

Operations Examples

More "screening" screens allow better removal of small objects.

Example For Rubble Cleaning

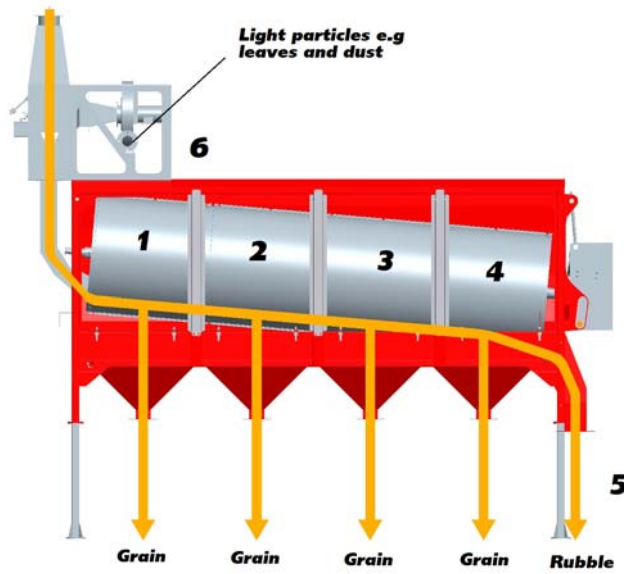

e.g.

1. 14mm / 20mm SQ Screen
2. 14mm / 20mm SQ Screen
3. 14mm / 20mm SQ Screen
4. 14mm / 20mm SQ Screen
5. Rubble
6. To Cyclone Separator

Example For General Cleaning

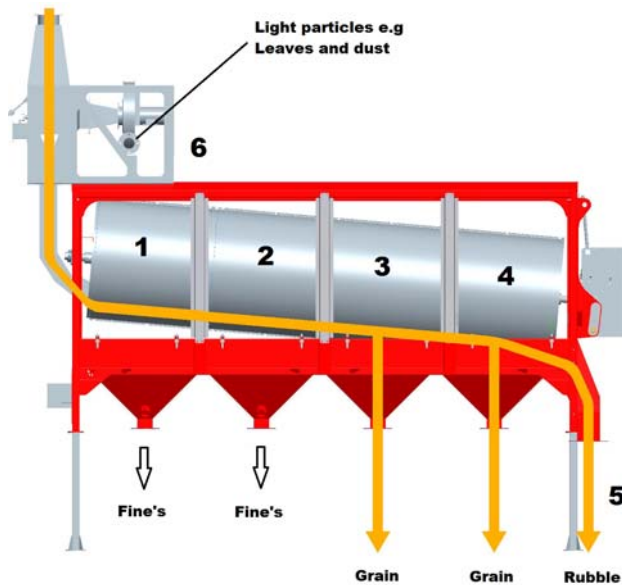

e.g.

1. 2.5mm / 4mm SQ Screen
2. 14mm / 20mm SQ Screen
3. 14mm / 20mm SQ Screen
4. 14mm / 20mm SQ Screen
5. Rubble
6. To Cyclone Separator

Example For Fine Cleaning

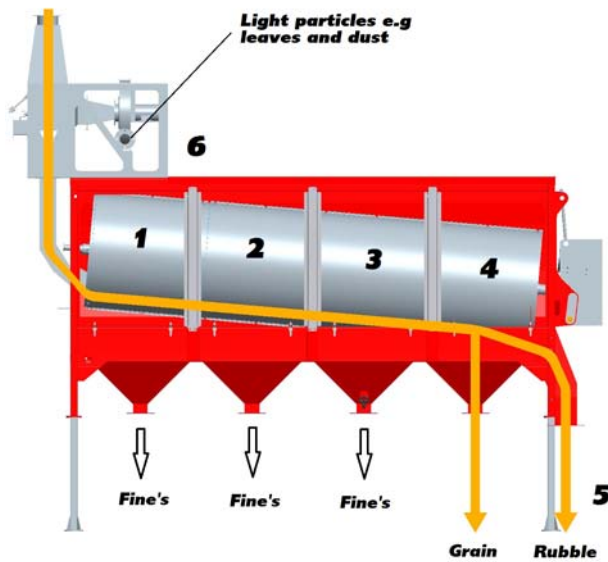

e.g.

1. 2.5mm / 4mm SQ Screen
2. 2.5mm / 4mm SQ Screen
3. 2.5mm / 4mm SQ Screen
4. 14mm / 20mm SQ Screen
5. Rubble
6. To Cyclone Separator

Any combination of screen's can be used depending on the grain type and / or harvest conditions.

Use

Adjustments

Avoid doing several adjustments at once, rather do single adjustments to get the required result.

Choosing the right screen for the desired result it is very important.

Aspirator

The grain must flow evenly through the aspirator (forming a curtain) and fill the whole width of the distribution flaps for efficient cleaning.

The counterweight adjustments is to determine the flow rate of the grain. More weight less flow rate, less weight more flow rate.

Grain Flow Distribution Flaps

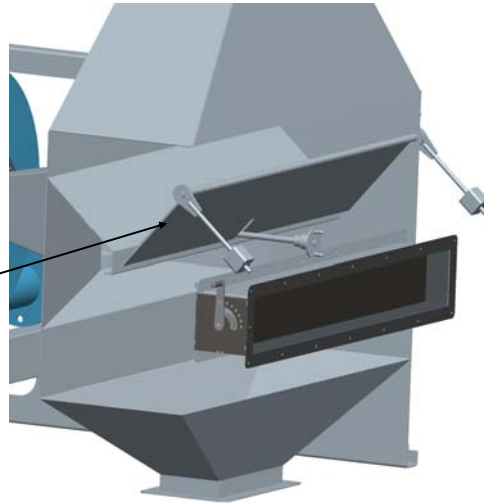

Adjustable Counterweights

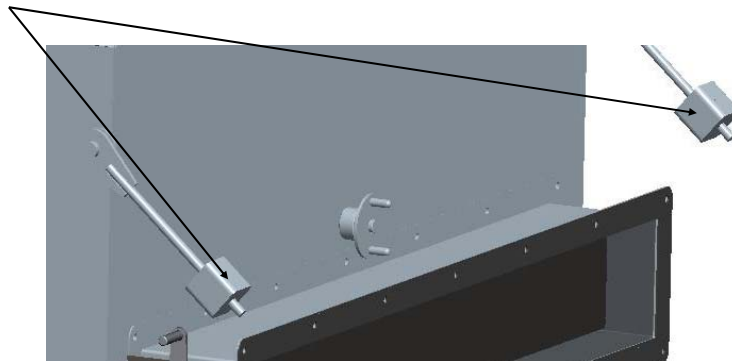

Drum

Before working inside the cleaner e.g. Working on the drum to change screen or for general maintenance power must be switched off for safety reasons.

The drum has a fixed rpm speed of 18rpm.

The working rotation of the drum turns in a clockwise direction, looking from the grain inflow side.

Fitting of the screen

Make sure power is disconnected.

Stop the drum and open the doors. Rotate drum to access the screen clamps. Loosen clamps and remove screens with a roll motion and feed the new screen onto the drum and secure with provided bolts and nuts. Insure that there is no abstraction of the drum when rotating the drum after installation.

Screen clamp

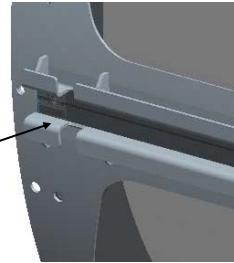

Variable drum angle

By adjusting the drum angle it is easier to clean dirty and wet grain.

For a more accrued cleaning you can set the pitch on Minimum.

Setting the drum angle to a minimum pitch, should give The grain a "large" cleaning period and therefore a cleaner result.

Variable pitch adjustment

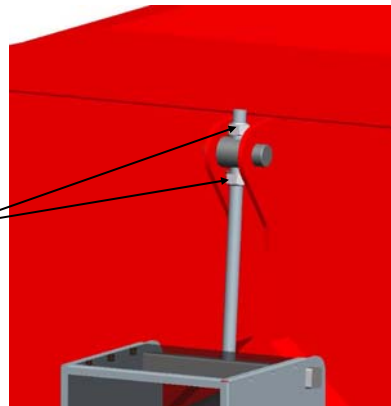

Access Point

When using the access points make sure you close the lever after it has been used.
These two access points are used to get samples of grain.
Use the access holes to get samples of grain being cleaned. Open the access caps to retrieve a sample and close after a sample has been retrieved.

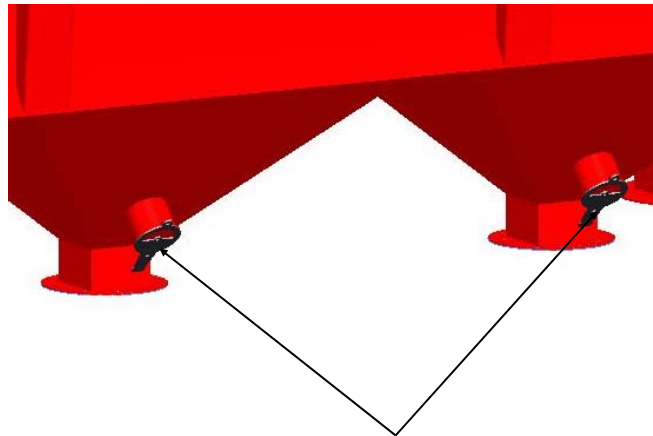

Access Point

Service.

Cleaning

The recommended cleaning and maintenance work should be carried out at regular intervals in order to maintain operational reliability and guarantee optimum performance.

Bearings and stickers should not be cleaned with a high-pressure cleaner or direct water jet. The seals and bearings are not waterproof under high pressure.

Serial Number Label

The implement serial number is indicated on the plate (see the example at the bottom). This information is useful when inquiring implement spare parts.



Lubricating

The grain cleaner should be lubricated regularly and after every pressure wash. This insures operational reliability and reduces the cost of repair work and down times.

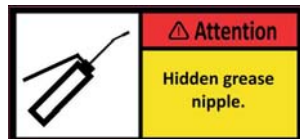
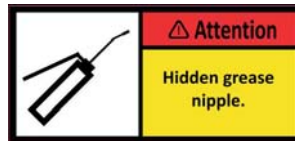
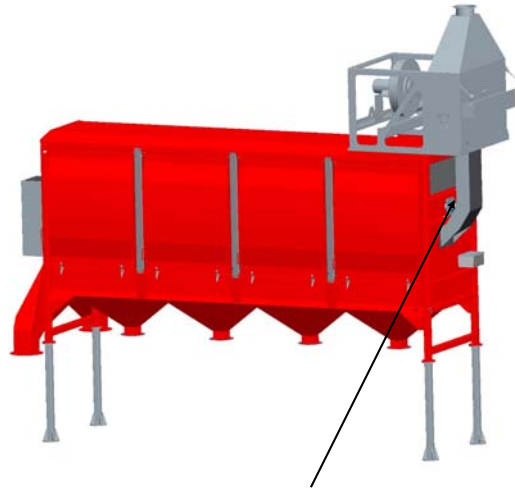

Gear box oil change interval

Oil must be replaced every 2500 hours or every 6 months. **NOTE* USE 3 LITER**

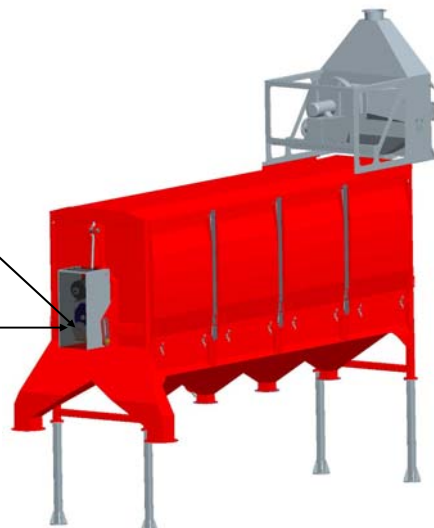

GC120-FF-01 Finale Fitment

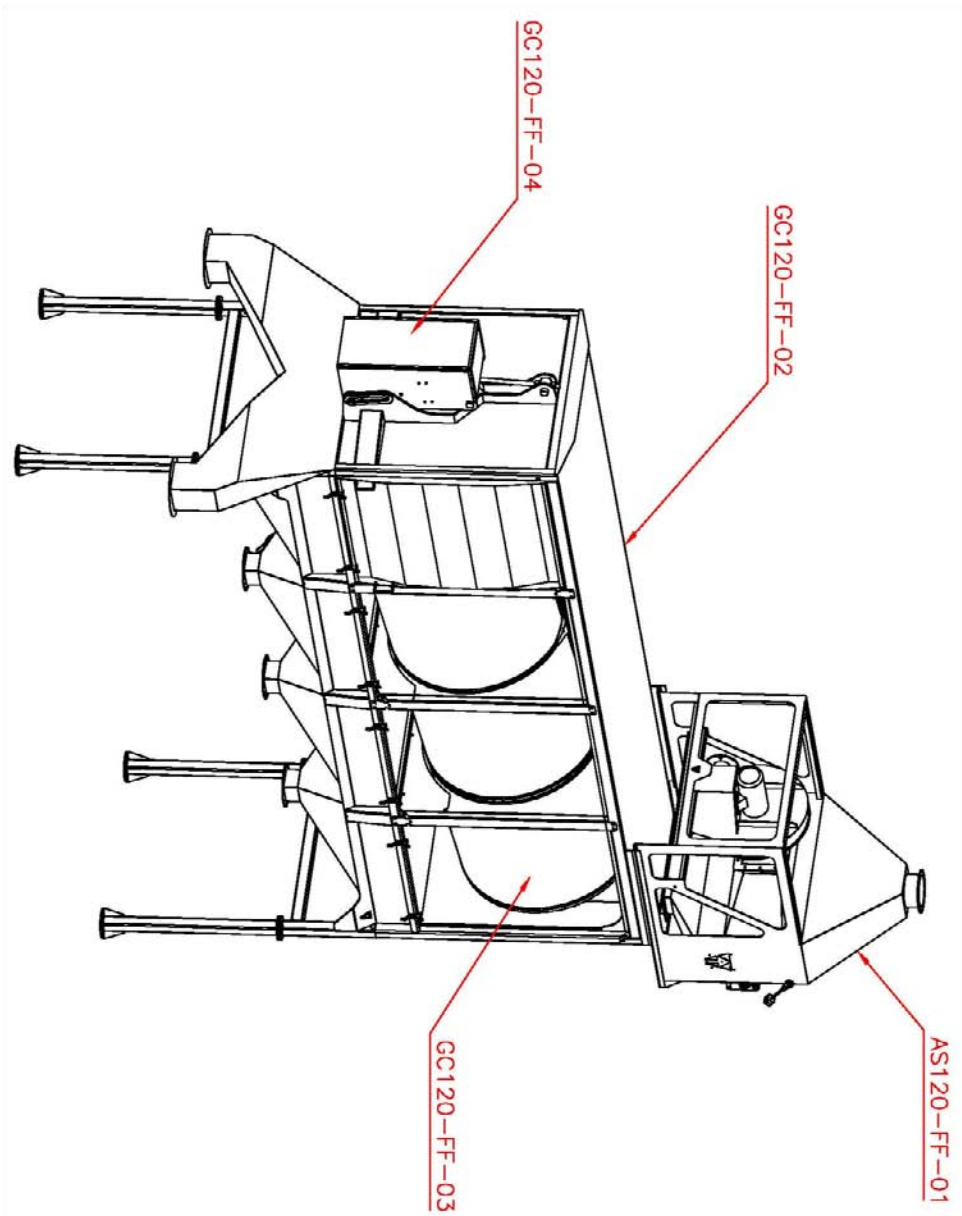

GC120-FF-02 Main Chassis Assembly

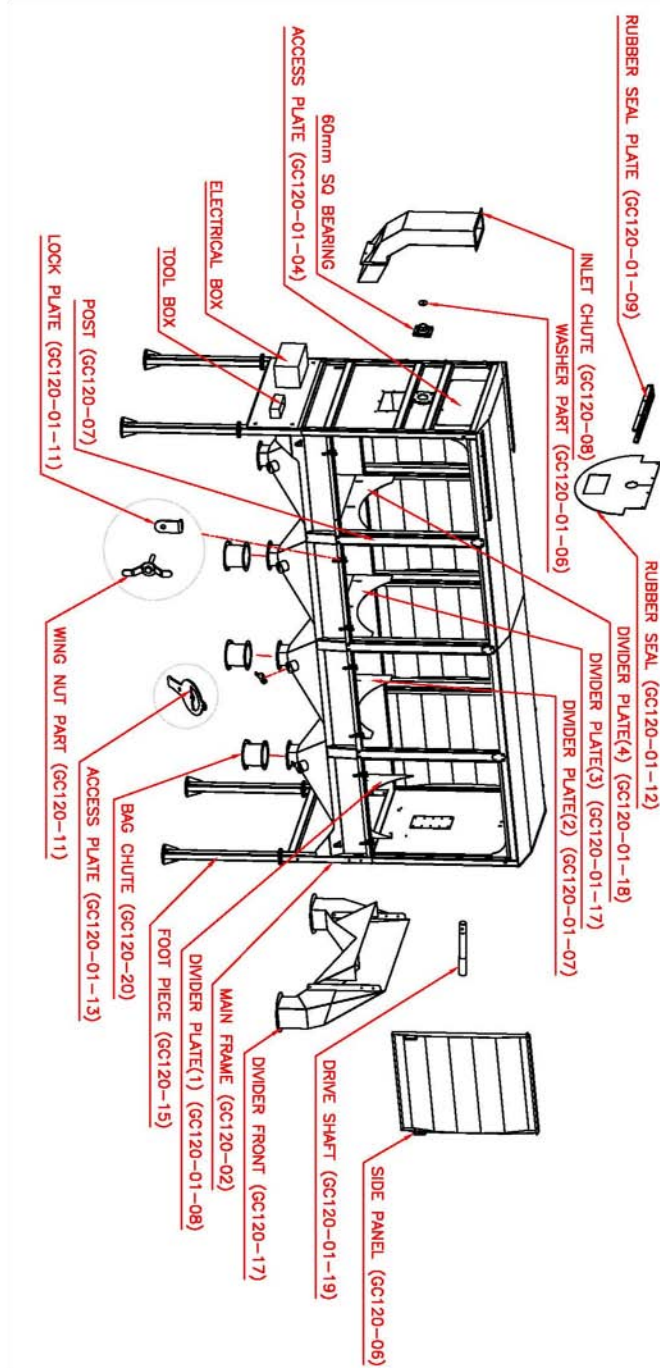

GC120-FF-03 Drum Assembly

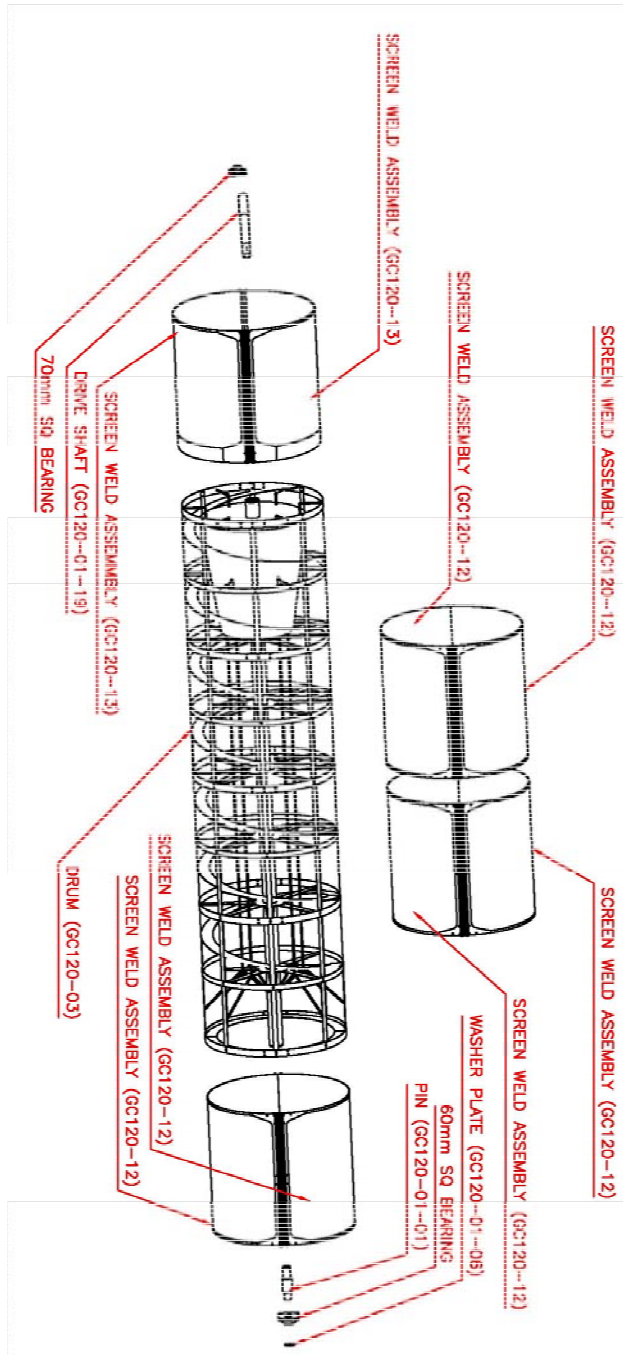

GC120-FF-04 Drive Train Assembly

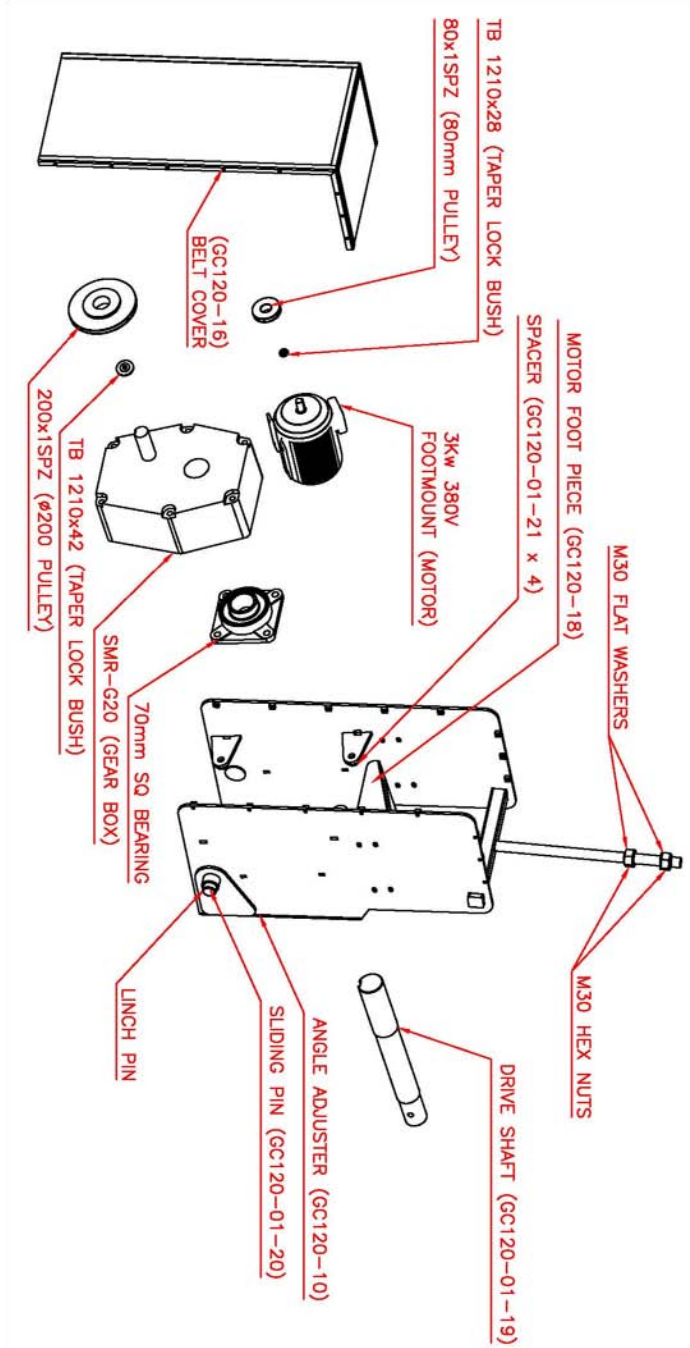

AS120-FF-01 Aspirator Assembly

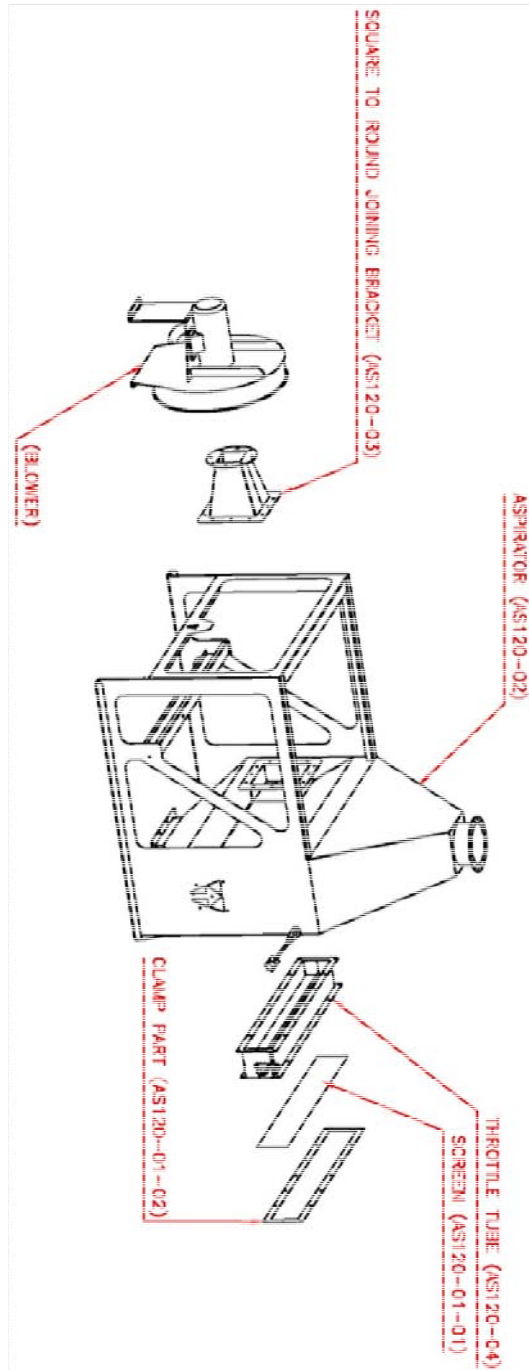

XU120-FF-01 Cyclone separator Assembly

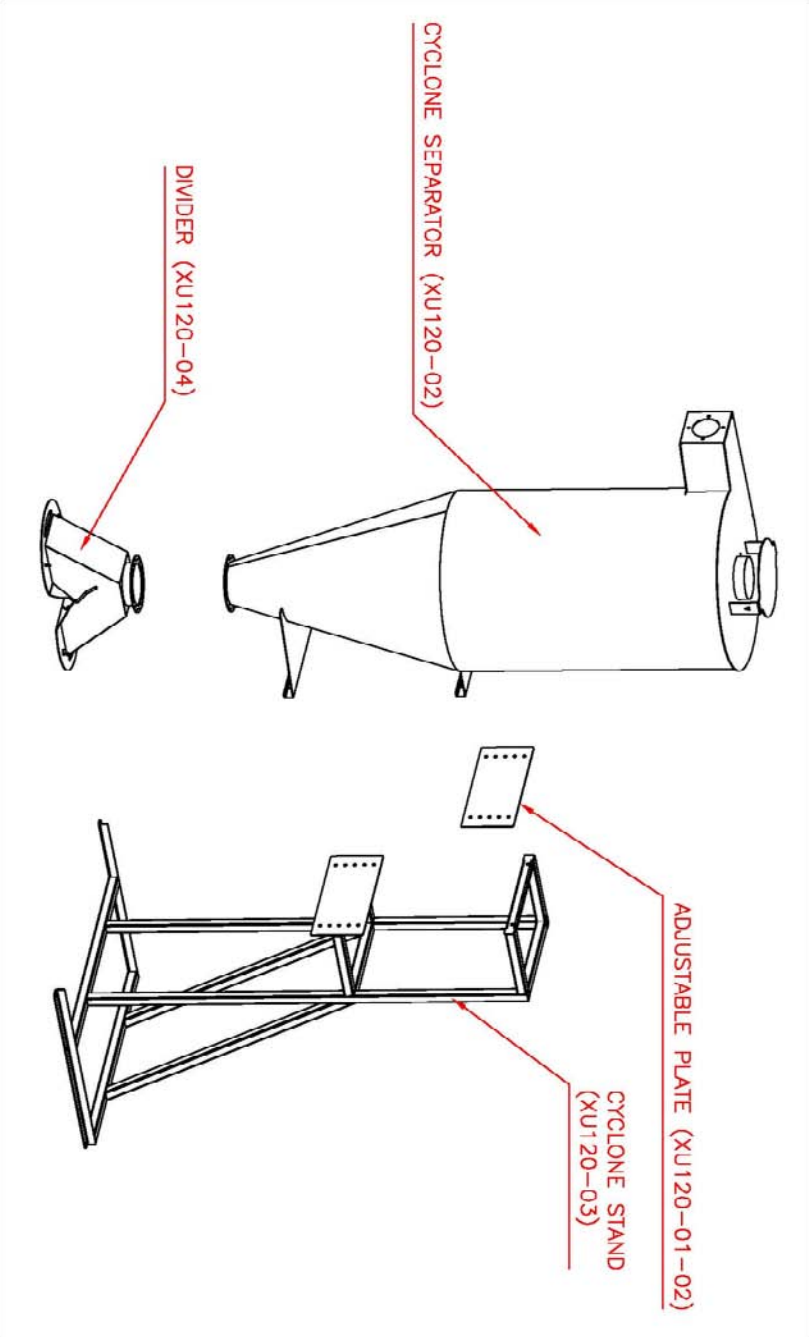

Basic aspirator and cyclone installation instructions

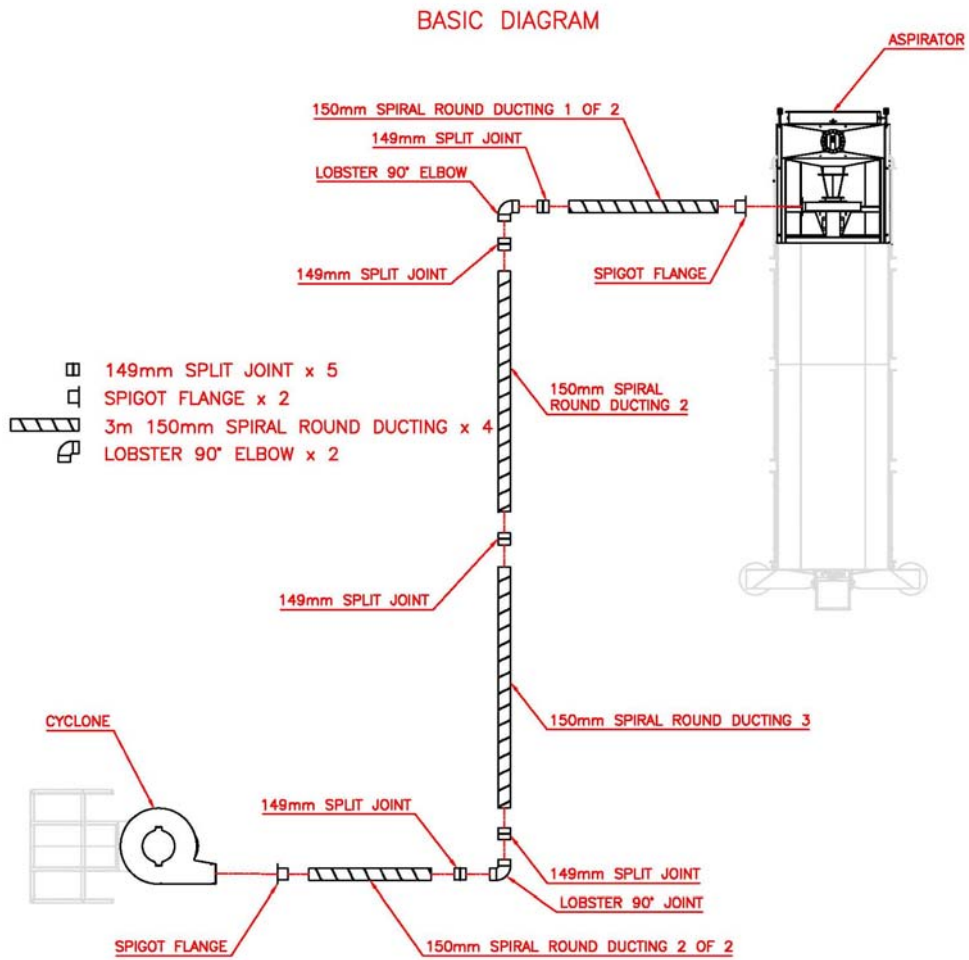

Basic installation instructions

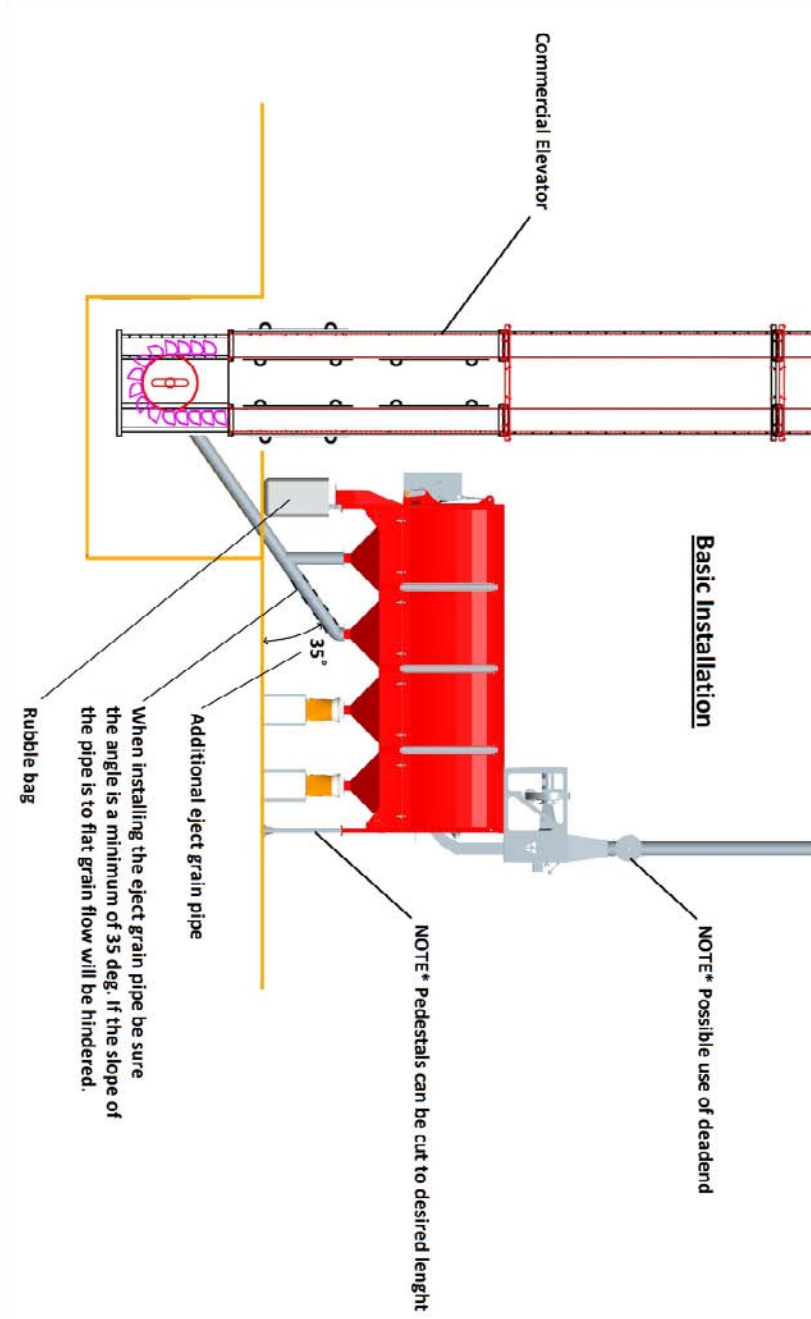

GC120 Electrical Diagram

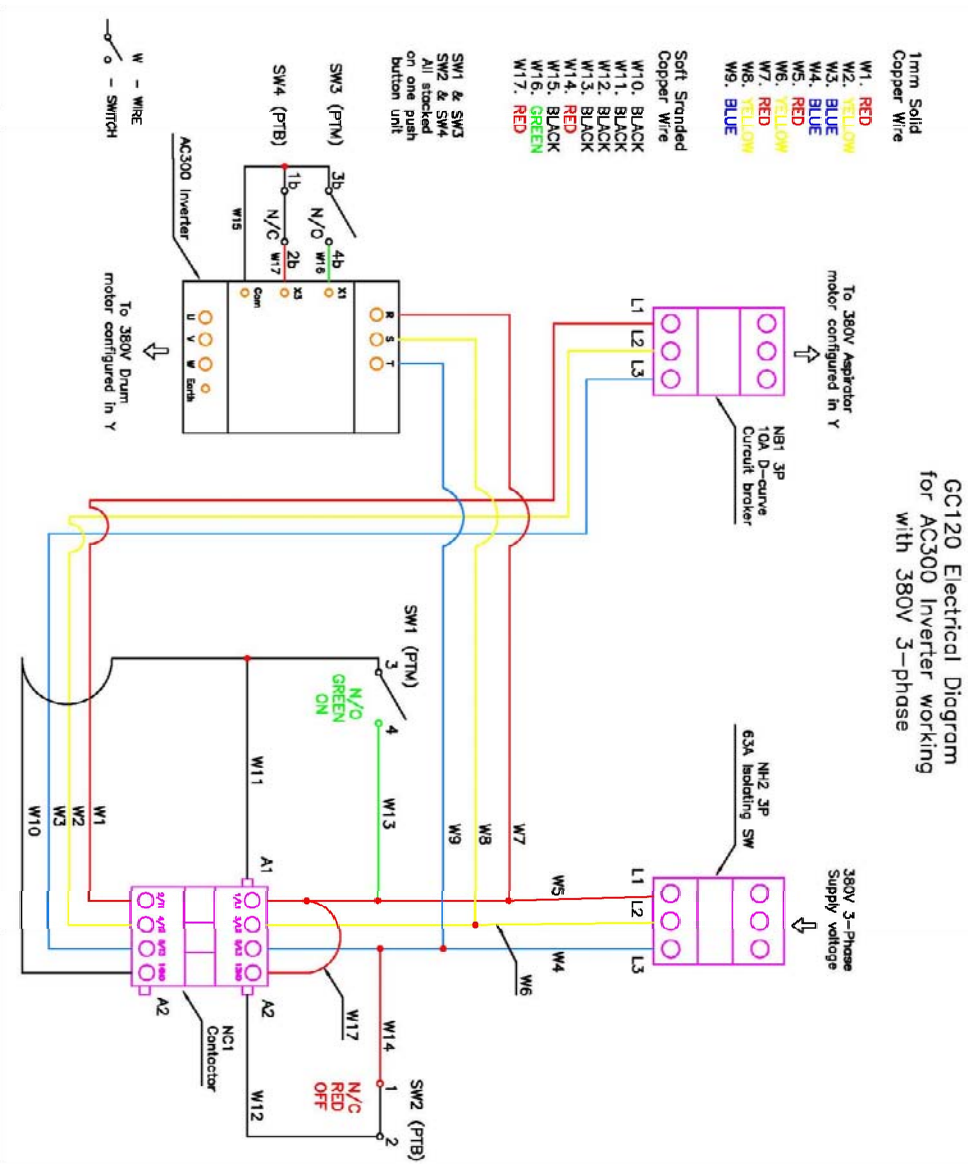

This page was left blank intentionally.



WARRANTY REGISTRATION

Dealer to complete and send to Info@agricad.co.za or fax to 0861001203

Implement:

Serial Number:

Dealer:

Customer Name:

Date of Sale:

Signature Client:

Dealer Stamp:

This implement carries a one year warranty on parts and workmanship under normal and intended use. This warranty is limited to the repair and/or replacement of defective parts.

No wear parts are covered under warranty.

This page was left blank intentionally.

Manufactured in South Africa
for African conditions by
AgriCAD Pty (Ltd)
www.agricad.co.za



AgriCAD © copyright
all rights reserved